

12M40

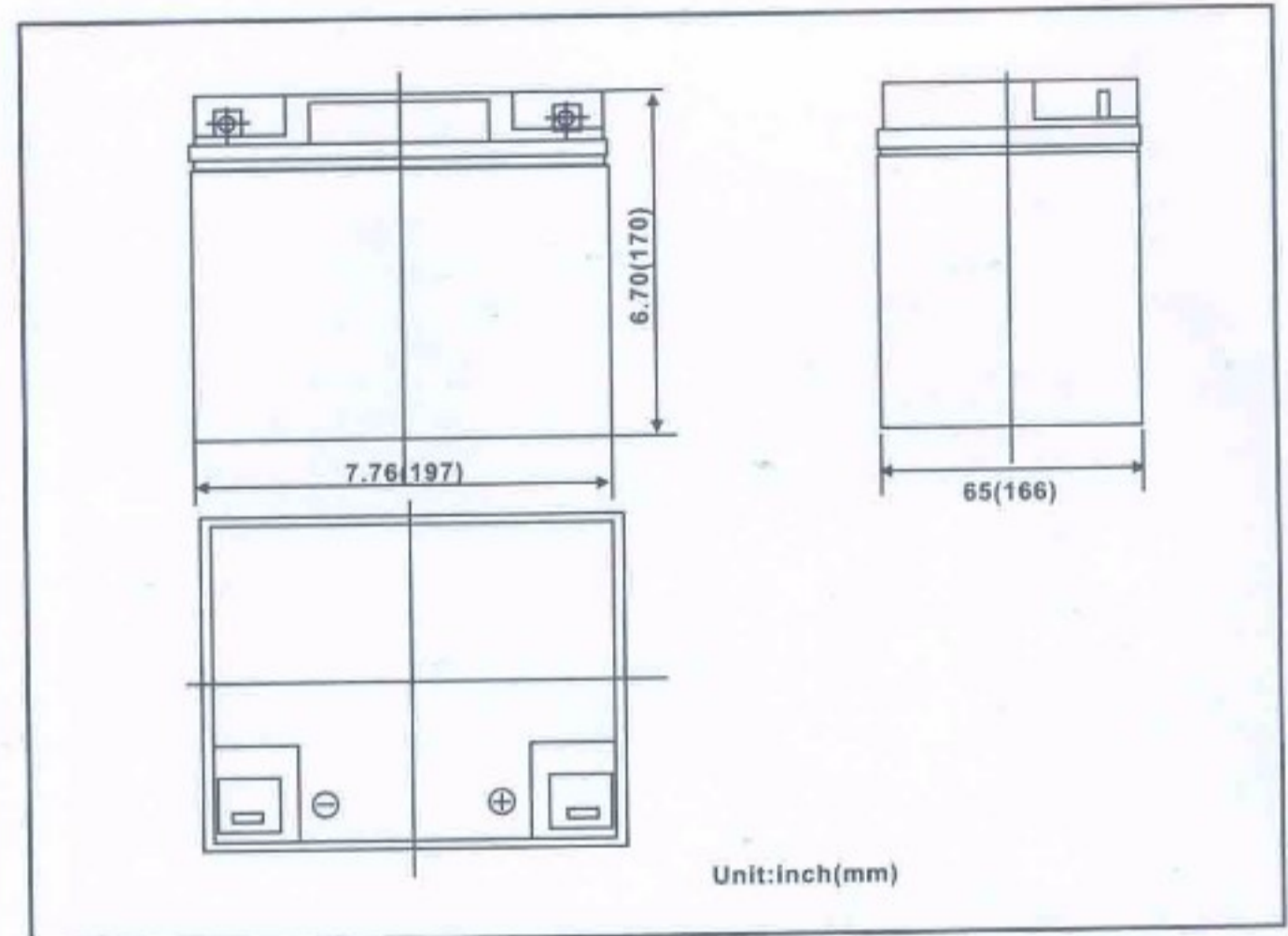

SPECIFICATIONS

Nominal Voltage		12V			
Nominal Capacity		40Ah			
Dimensions	Length	7.76 inches(197mm)		Weight	Approx 29.3lbs (13300g)
	Width	6.5 inches(166mm)			
	Height	6.7 inches(170mm)		Terminals	F6(standard)
	Total Height	6.7 inches(170mm)			
Capacity 77°F(25°C)	20 hour rate(2000mA)	40 Ah	Constant Voltage Charge	Cycle	Initial Charging Current less than 12A Voltage 14.5-14.9V at 77°F(25°C)Temp.coefficient -30mv/°C
	10 hour rate(3600mA)	36 Ah			
	5 hour rate(6300mA)	31.5 Ah			
	1 hour rate(24700mA)	24.7 Ah			
	15 minute rate(66A)	16.5 Ah			
Capacity affected by Temperature	104°F(40°C)	102%	Standby	Initial Charging Current less than 12A Voltage 13.50-13.80V at 77°F(25°C)Temp.coefficient -20mv/°C	
	77°F(25°C)	100%			
	32°F(0°C)	85%			
	5°F(-15°C)	65%			
Internal Resistance	Full charged battery 77°F(25°C) < 8.5mΩ				

